

MONTVILLE MEMORIAL PROJECT

Possible features: Yarning Circle, Paths, standing trunks, cedar stump

Prepared by Cate Patterson
Feb, 2026 for MVA

Creating a memorial space
that is peaceful, unifying
and inspirational

Rock wall separating
driveway and Peace Place,
Inclusive viewscape from
St Marys Hall

Montville Medallion





MEMORIAL GATES
MONTVILLE

AN EVERY DAY LIVING MEMORIAL FOR CONNECTING WITH EVERY DAY

QUALITIES OF OUR EXISTING MEMORIAL

- Provides an opportunity to remember
- Foregrounds harmony with gentle landscape architecture
- Inclusive, non judgemental
- Creates a Space that blends the sorrow of loss with the joyful appreciation of what has been protected and passed on to us

THE STAKEHOLDERS

- Montville Community
- Jinibara People
- Mapleton RSL sub-branch
- Department of Environment, Tourism, Science and Innovation (DETSI)
- Sunshine Coast Council (SCC)
- State Government
- Federal Government
- Authors of the 2023 Conservation and Management Plan (CMP)

THE BRIEF



- Consider ways to provide a physical memorial to commemorate the many conflicts involving this country
- Design options to explore opportunities and constraints
- Enhance heritage significance of the Memorial Precinct

LOCATION PLAN



Roger Todd was asked by the Montville Village Association, custodians of the Hall and Memorial, and within the Montville Memorial Precinct, to consider ways to further reflect on and provide a physical memorial to commemorate the many other conflicts involving this Country

The World War I memorials at Montville (1921 gates and 1923 memorial trees) reflect a period of strong and widespread Australian patriotism and nationalism 1

This design work was intended as a first investigation towards a more *comprehensive architectural/artistic proposal/realisation* - It explores opportunities and constraints with the aim of enhancing heritage significance

The place is State heritage listed, and the adjacent St Mary's Anglican Church is locally listed

Enhancements to the memorial aspects of the place will require the Villiage Association to gain approval and cooperation from a wide range of stakeholders including the State and Federal Governments, the wider community, the Department of the Environment, Tourism, Science and Innovation (DETSI), the Sunshine Coast Council, the RSL, & the authors of the 2023 CMP

Future work will require a detailed site survey and laser scanning for treetop walk

1 from the State listing



Additions to the Montville War Memorial

Location Plan
 Conception Stage
 1:1000 at A3 Jan 2026 1252/01



Treetop
Walk and
Viewing
Platform
From the
Deck

OPTION 1A MEMORIAL TREE WALK

Description

- Boardwalk 2.4m wide
- Approx 15m out from deck
- 12m above ground level
- Circular viewing platform 8.5m diameter
- floor level steps down for uninterrupted view over balustrade
- Bunya Dreaming

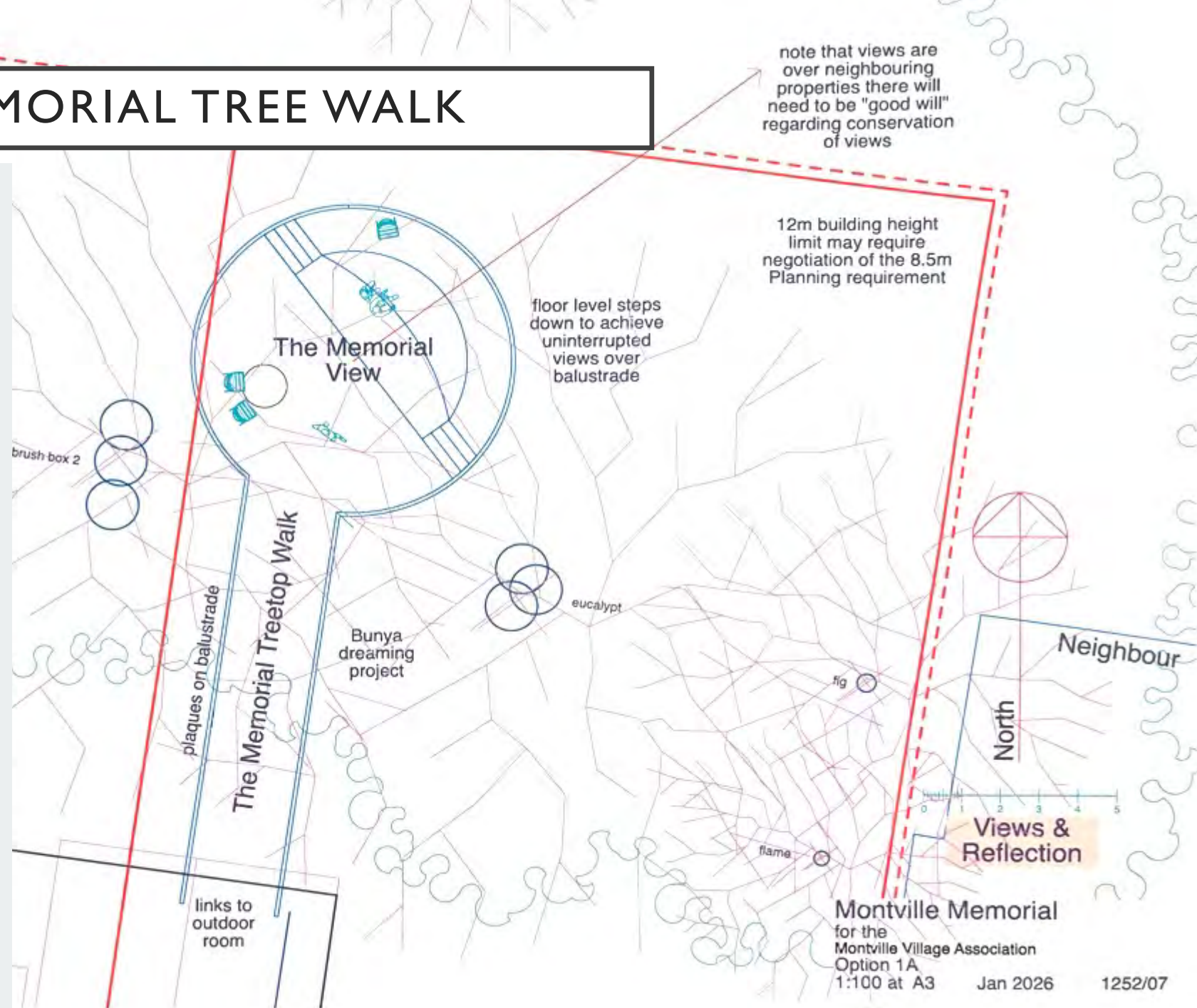



BUNYA DREAMING PROJECT

AIM:

- To see bunya pines in the viewshed from the Treetop Walk
- To acknowledge the significance of Bunya gatherings held in traditional Jinibara country
- To acknowledge the Black Wars of the 1840s and 1850s
- (From the Jinibara Traditional Inputs for the Sunshine Coast Heritage Study for Sunshine Coast Regional Council)

CONFLICTS BEFORE WORLD WAR I

- The Frontier Wars
- The Black Wars of the 1840s and 1850s
- The New Zealand Wars 1845-1872
- Sudan 1885
- The Boxer Rebellion 1900-1901

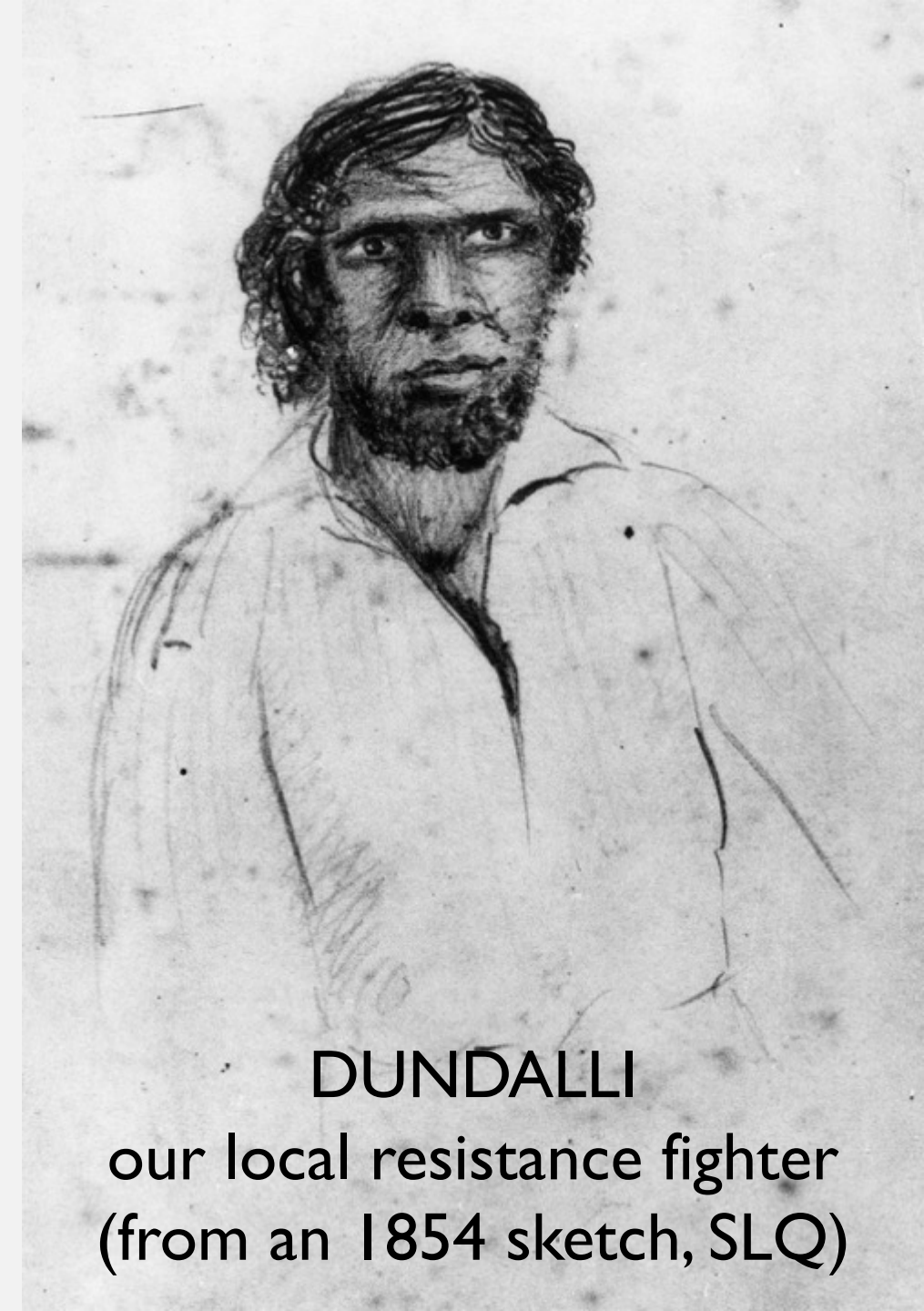

DUNDALLI

our local resistance fighter
(from an 1854 sketch, SLQ)



VIEW TO
MT
COOLUM

WITH
BUNYA
TREES IN
THE VIEW
SCAPE

Considerations

- Local council 8.5m height restriction
- Considerable Geotech engineering and laser surveying
- Goodwill from neighbours
- Safety issues
- Steps on platform reduce wheelchair access
- Affect on current insurance costs
- Affect on spaces below
- practicality

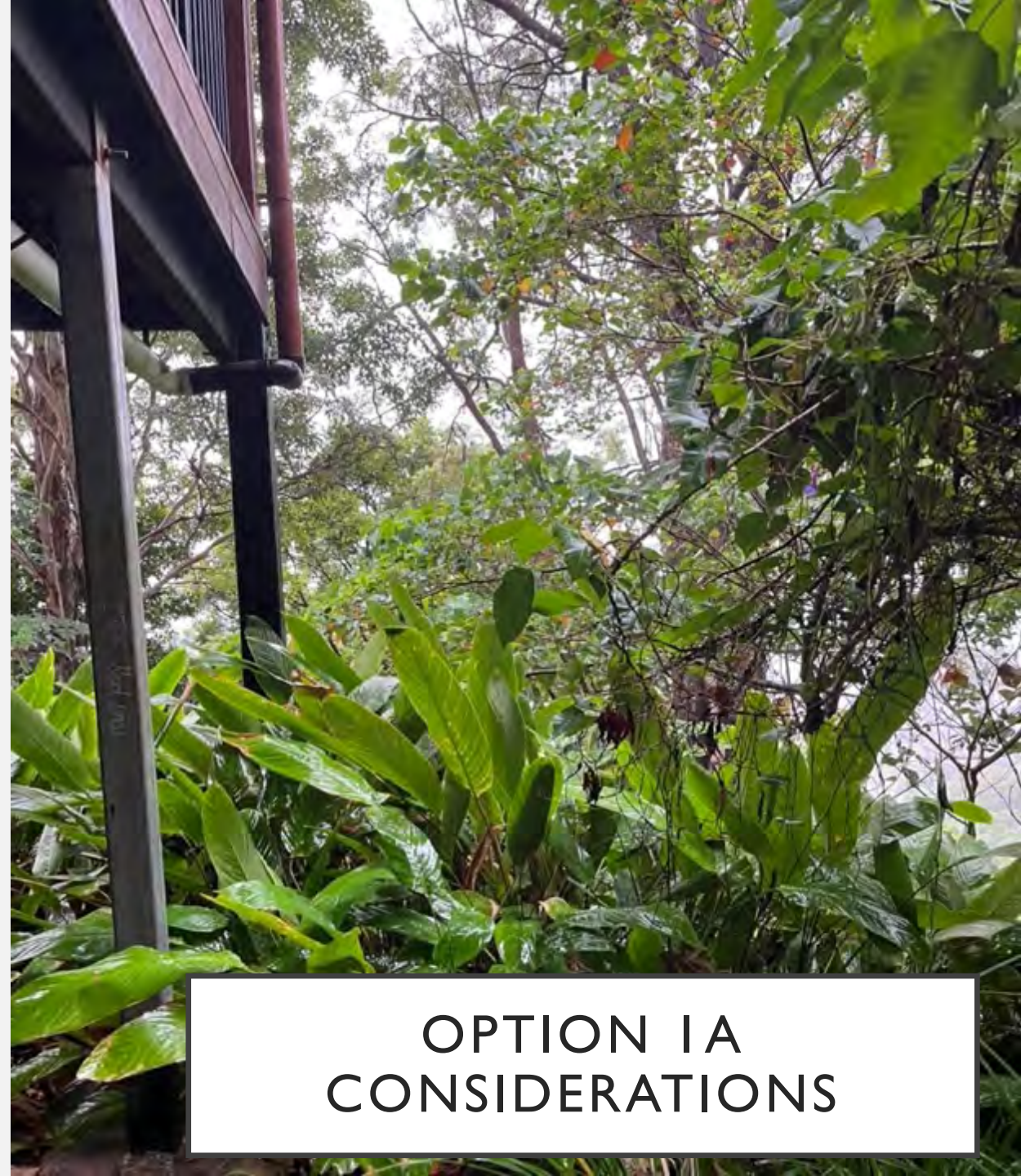

OPTION 1A
CONSIDERATIONS



PEACE
PLACE

AND
TEA
GARDEN

1B CIRCLE OF REFLECTION & TEA GARDEN

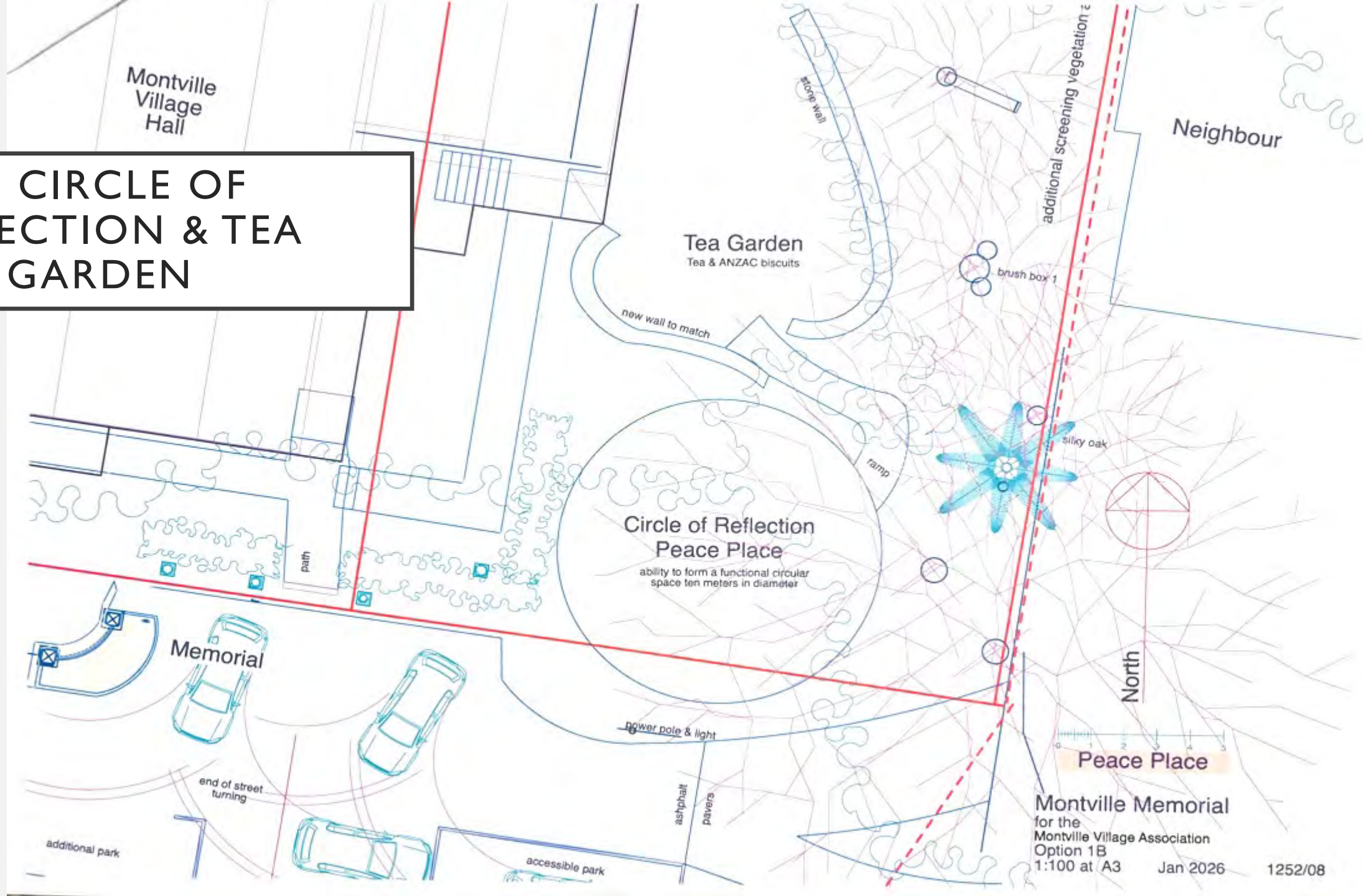

CIRCLE OF REFLECTION

Description

- Level circular space, 10m diameter, ramp curving down to 2nd level space partly enclosed by new stone wall to match existing wall

Considerations

- Bin enclosure to be relocated
- Power pole and light to be relocated
- Replacement of 2 flag poles for one that carries three flags
- Sensory planting, tucker food planting, screening planting
- Location of Plaques

CONFLICTS SINCE WW2

- The Malayan Emergency 1948 to 1960
- Korean War 1950 -1953
- The Indonesian Confrontation 1962 - 1966
- Vietnam War 1962 – 1975
- Gulf War 1990 – 1991
- War in Afghanistan 2001 – 2021
- Iraq War 2003 – 2013
- Peacekeeping since 1947
- DVA (Department of Veterans' Affairs) (2025), Wars and peacekeeping missions involving Australia, DVA Anzac Portal, accessed 20 April 2025, <https://anzacportal.dva.gov.au/wars-and-missions>

IC RESTORE VIEW

Description

- Relocate Amenities Block
- Paved access path
- Plaques

Considerations

- Long Term Planning SCC
- Power pole
- Flag Pole
- Alterations to car turning carparks

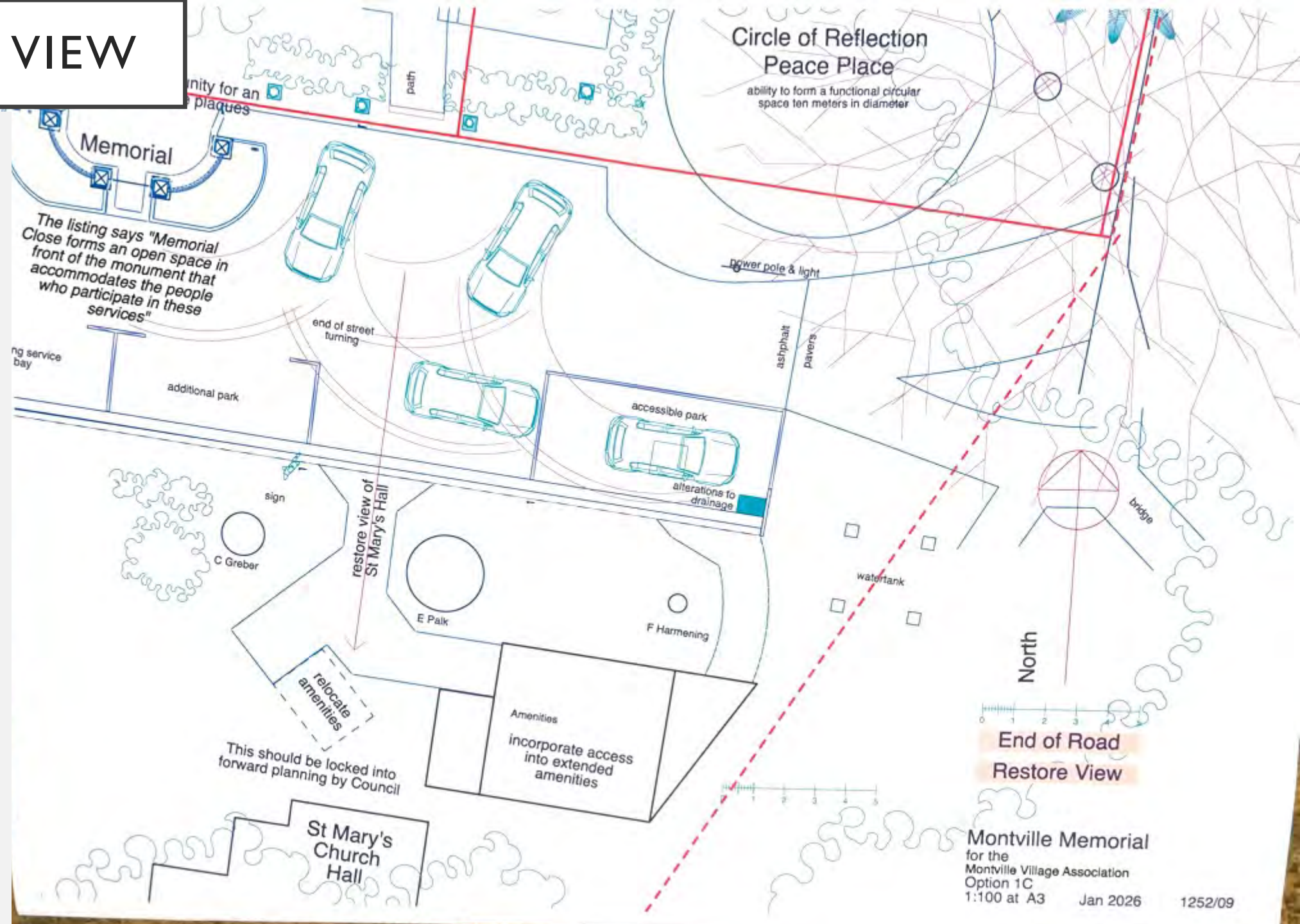

2A REFLECTION TRAIL

Description

- 80m x 1.5m trail
- Launch from Tea Garden
- 1 in 14 gradient
- Plaques, butterfly, bush tucker, screening, sensory

Considerations

- Extensive disruption to forest floor excavation and levelling machinery
- slip prone area
- Proximity to neighbour

Trail Option

Trail could be a board walk and not impact the floor as much
Still have considerable disruption during construction

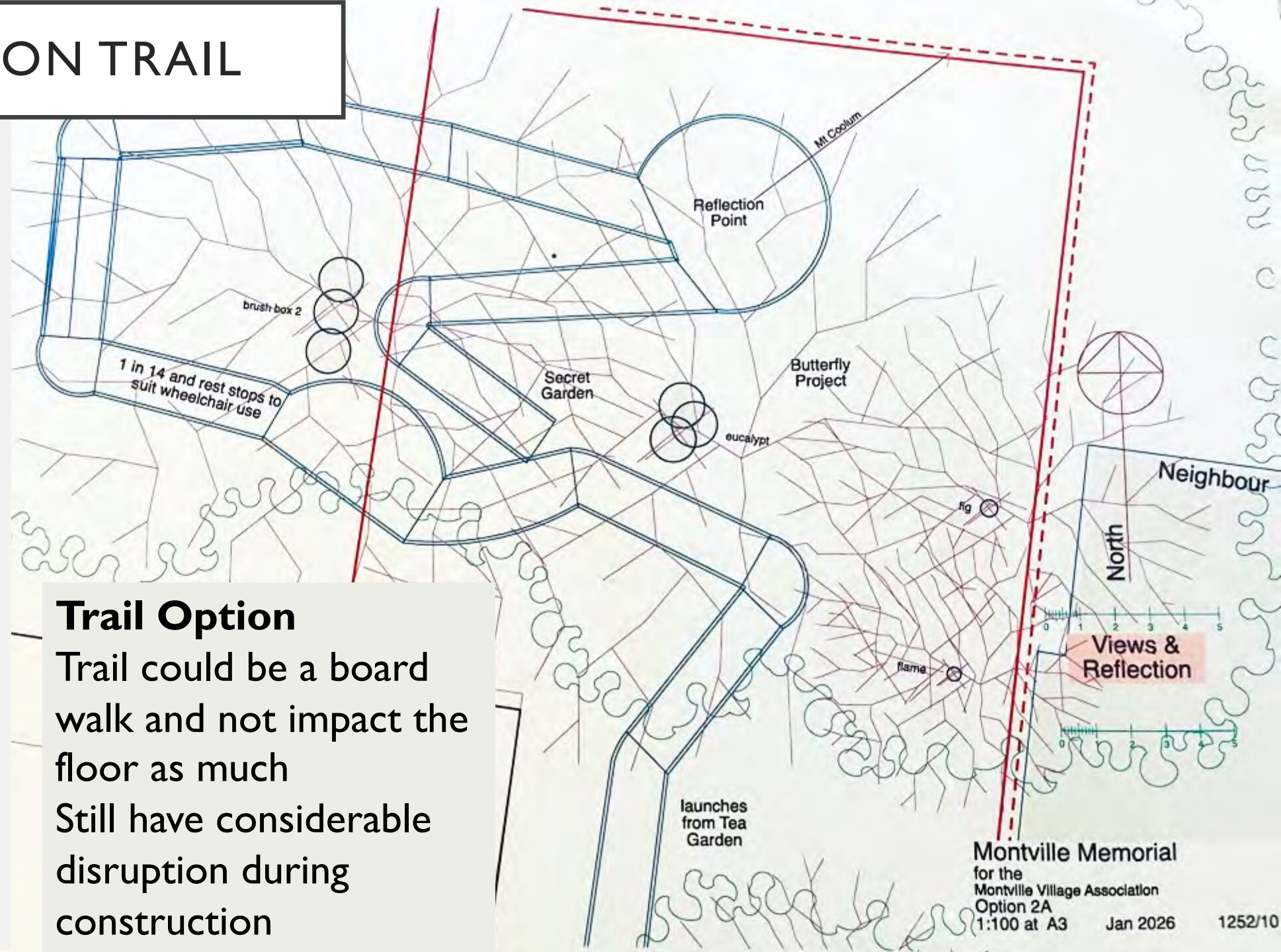

2A BOARD WALK OPTION

- Protects existing plantings
- Provides for butterfly project bush tucker sensory plants screening plants
- Incidental sculptures
- Secret garden etc



OPTION 2B CIRCLE OF STONES

Description

- 10m wide circle(1B)
- enclosed by large boulders
- Plaques
- Sculptural opportunity

Considerations

- Safety
- Inclusive
- Multi-functional

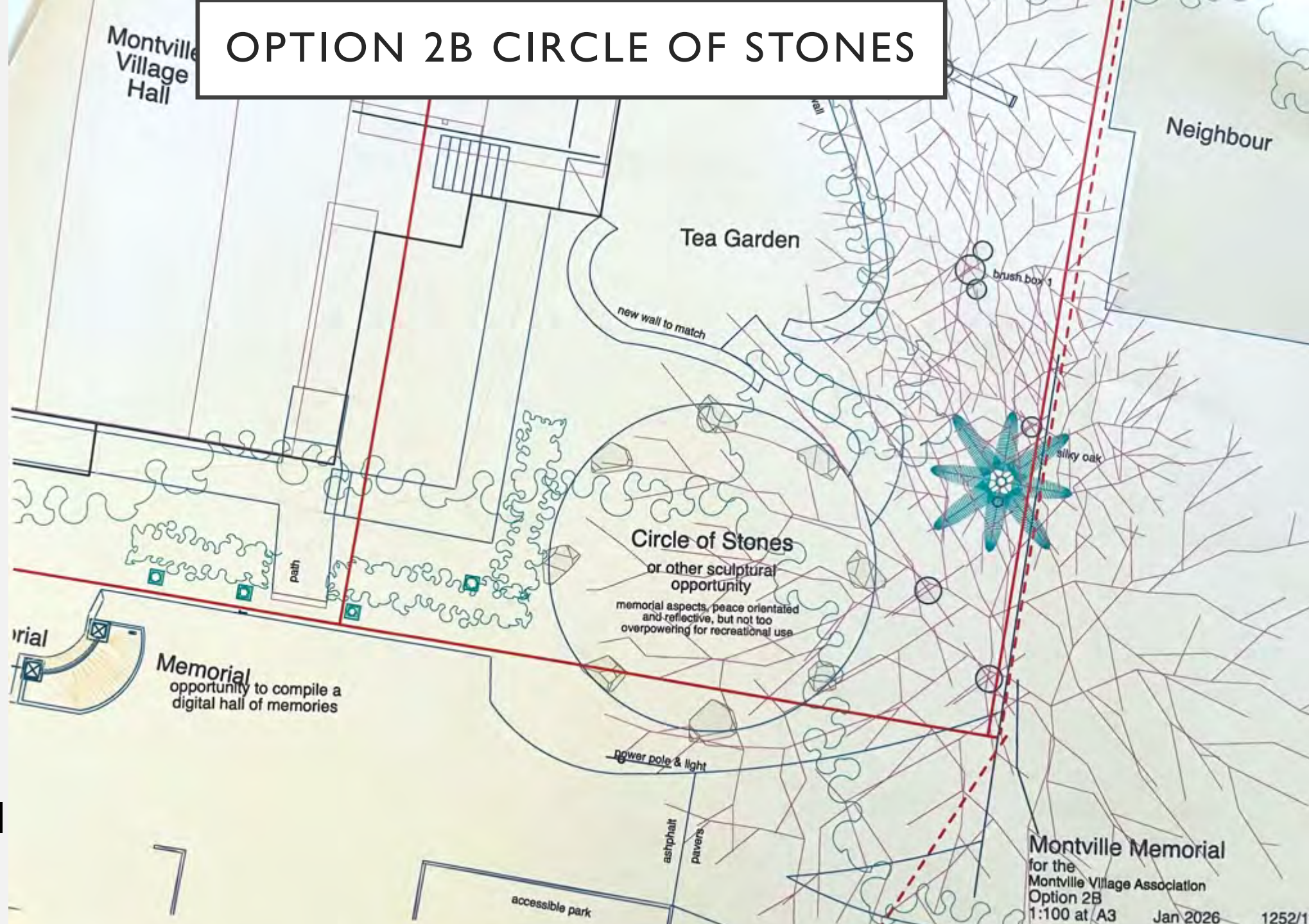

- 
- OPTION
 - Could be standing stones
 - Non-circular arrangement
 - Other features included

OPTION 2C FROM THE GREEN

Description

- Dedicated Memorial Place
- Village Green

Considerations

- Relocate signage, bins, table
- Gate replaced with pop-up bollards
- Car park spaces
- Consult SCC

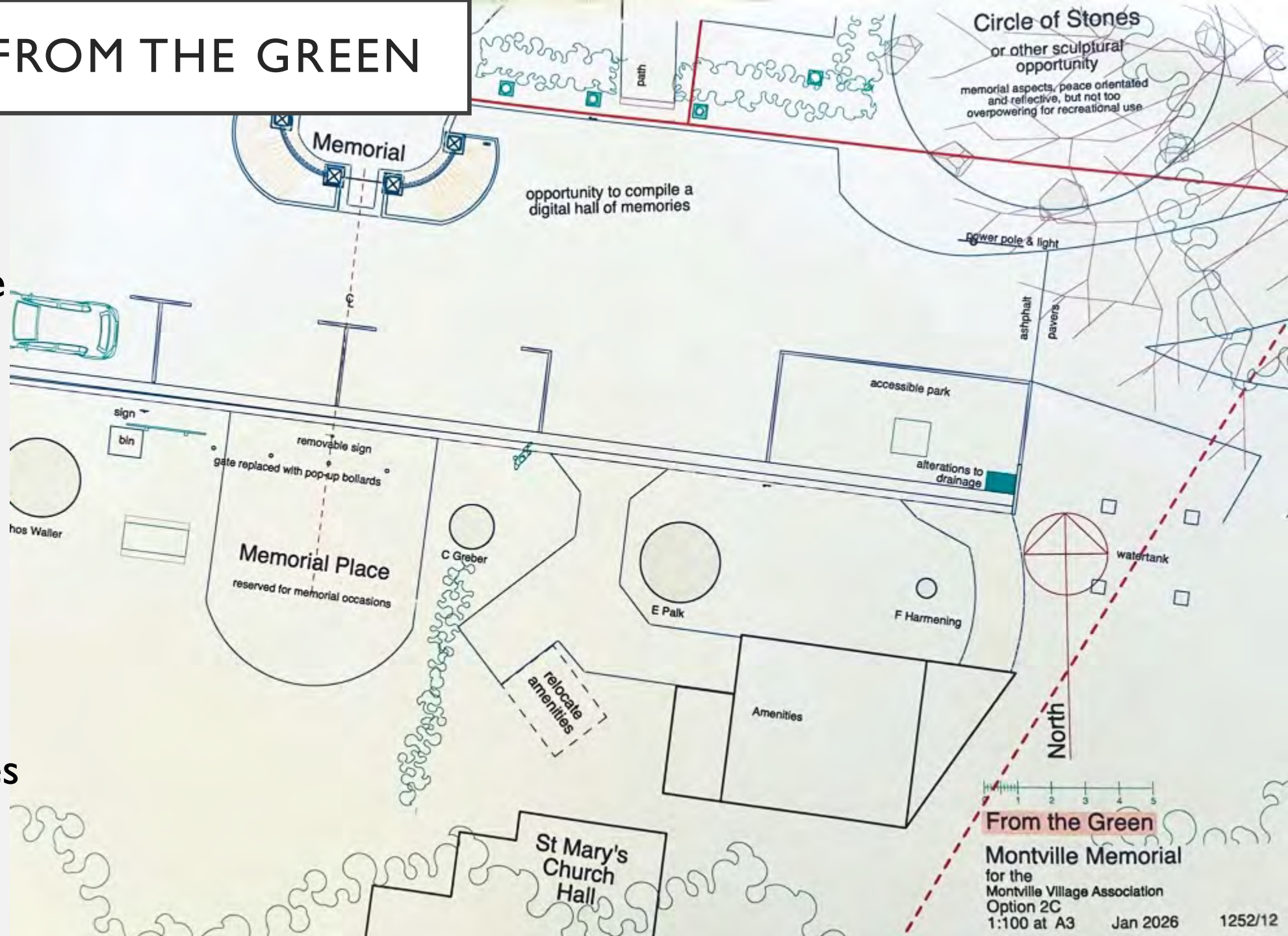

OPTION 2C

MEMORIAL
PLACE

ON THE
GREEN



OPTION 3A VIEWING STAGE

Description

- Boardwalk 10m x 2.4m
- viewing stage 10m x 7.5m
- 10m height
- 3 steps down to stage
- Launches from Tea Garden

Considerations

- Use?
- Practicality?
- Geotech engineering and laser survey required

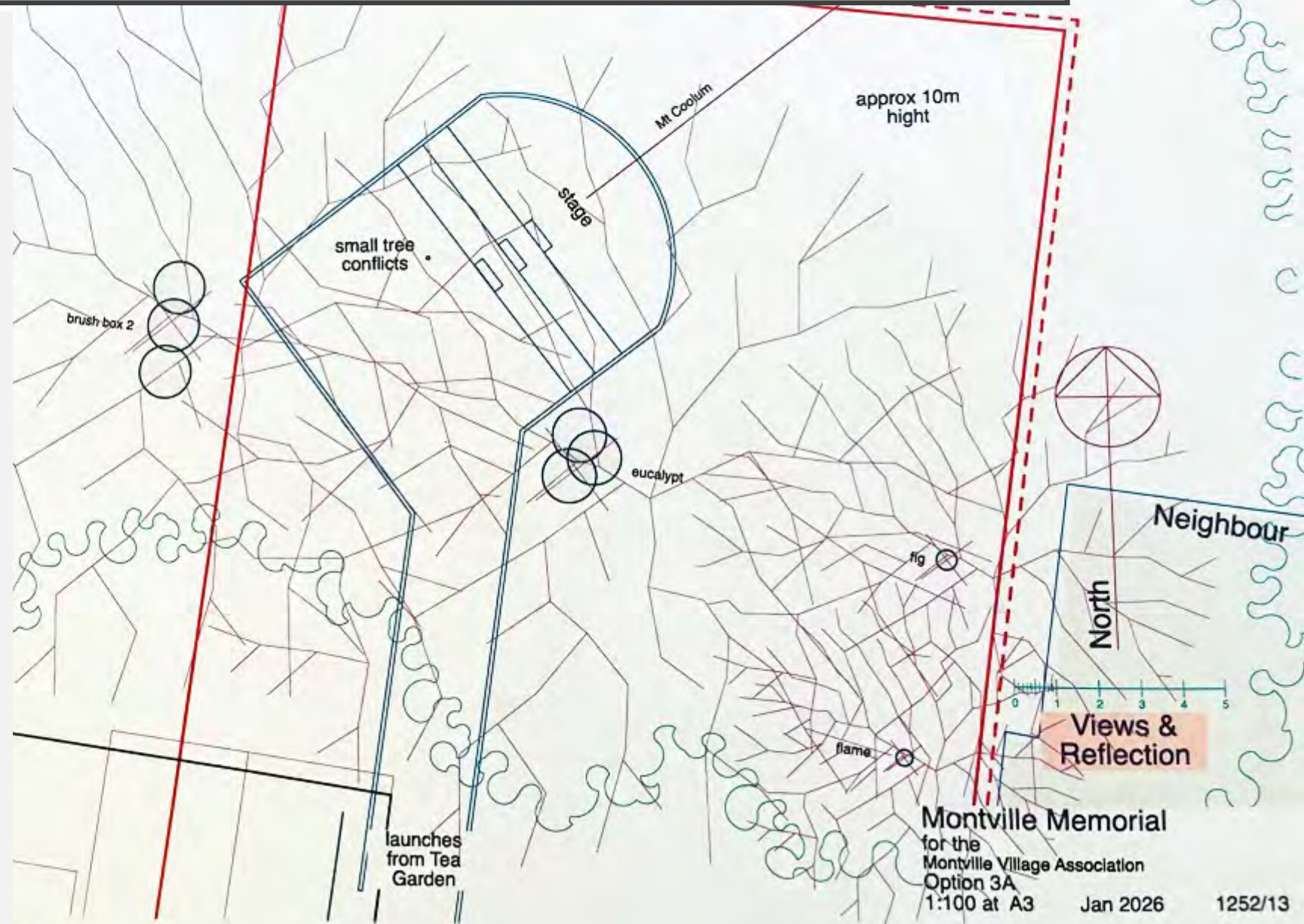



OPTION 3A
BOARD WALK AND VIEWING STAGE

Description

- Relocate Amenities Block
- Access path between amenities and Memorial Gate

OPTION 3C OPEN UP A CEREMONIAL AREA AND IMPROVE VIEWS OF MEMORIAL GATE AND HALL

Considerations

- Long Term Forward Planning with SCC
- Two bays for service access
- No Parking between 5am and 2 pm,
- Relocate gate, signage, bins, table and seating
- Similar to Option 2C but less formalised

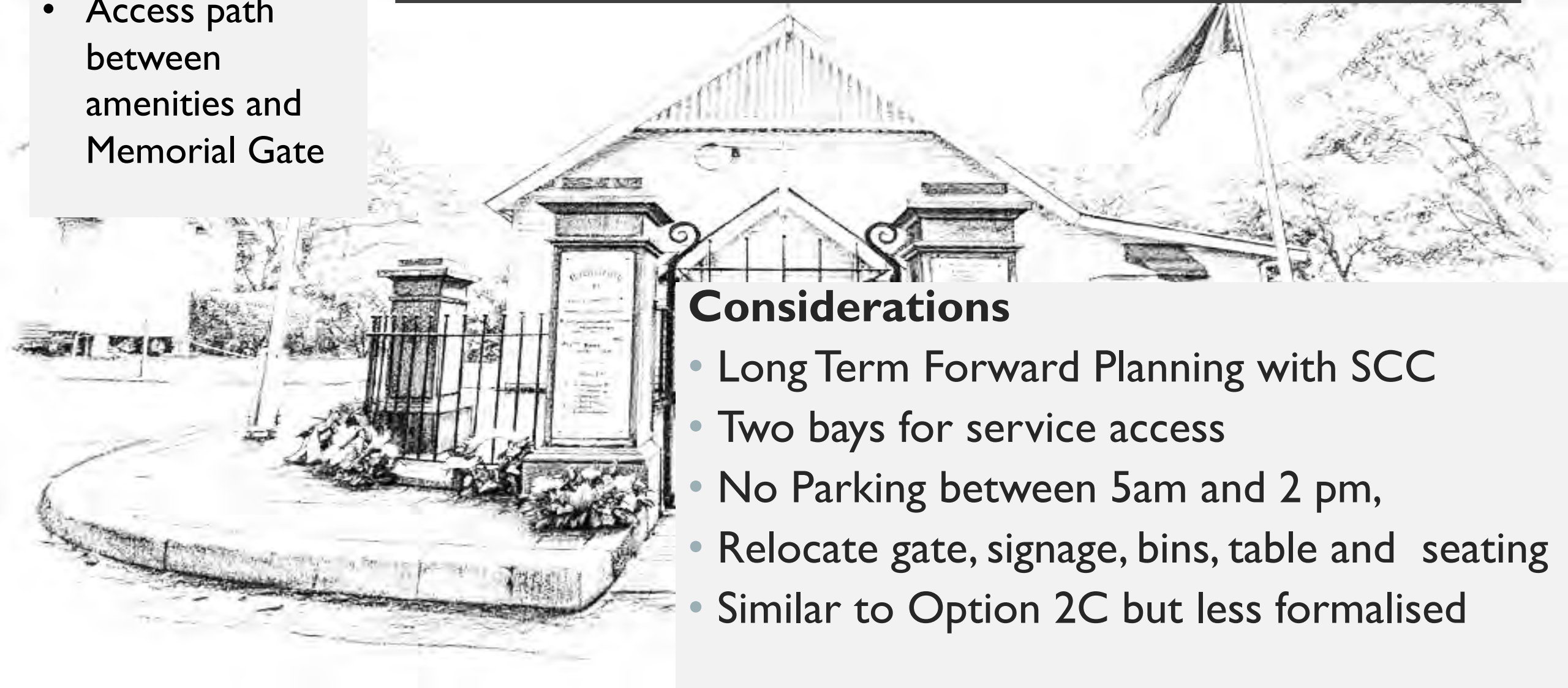

Description

- As for 1A
- 3 metre-wide steps down to viewing platform
- Launches from deck

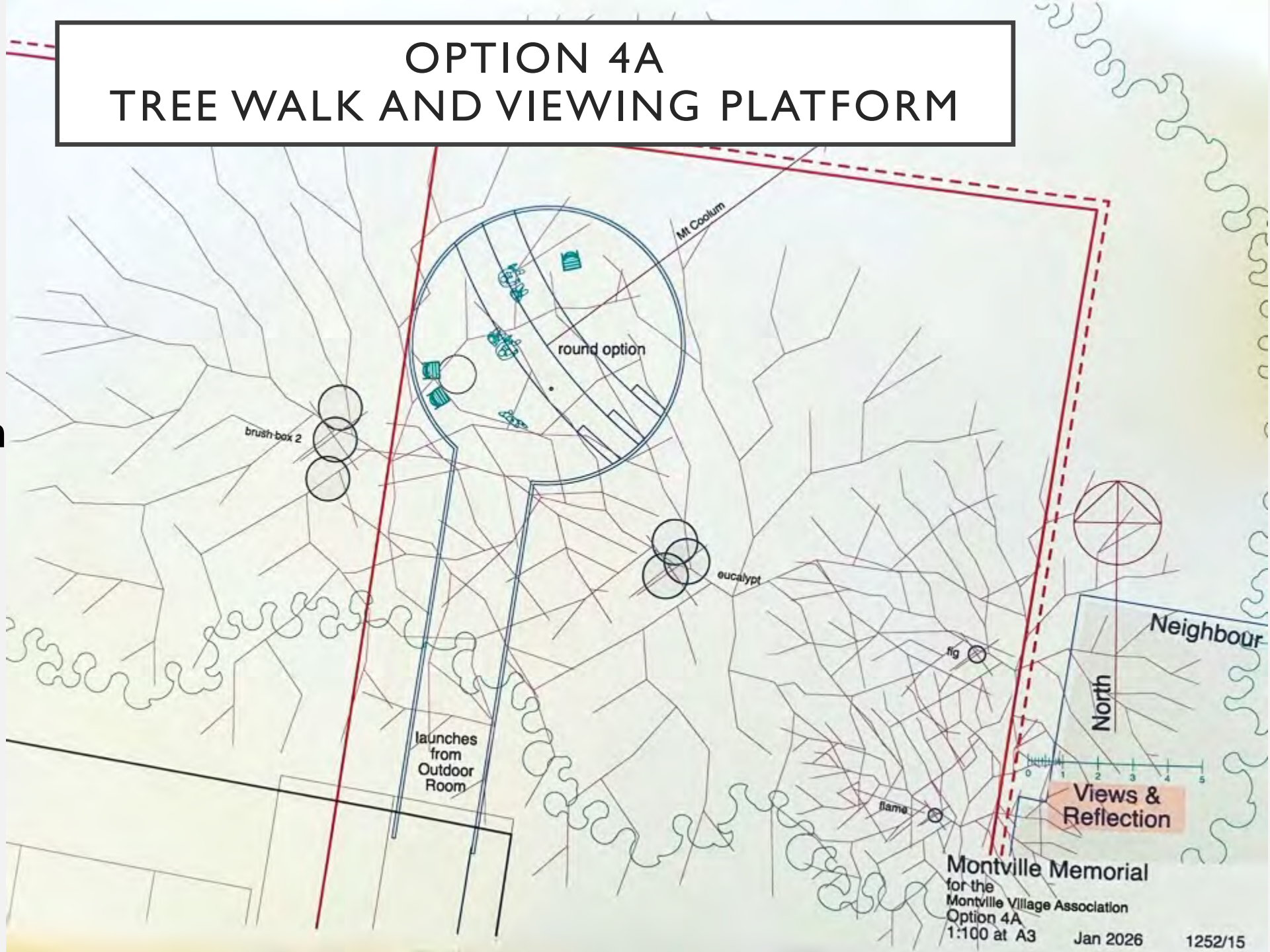

Considerations

- Local council 8.5m height restriction
- Considerable Geotech engineering and laser surveying
- Goodwill from neighbours
- Safety issues
- Steps on platform reduce wheelchair access
- Affect on current insurance costs
- Affect on spaces below
- practicality

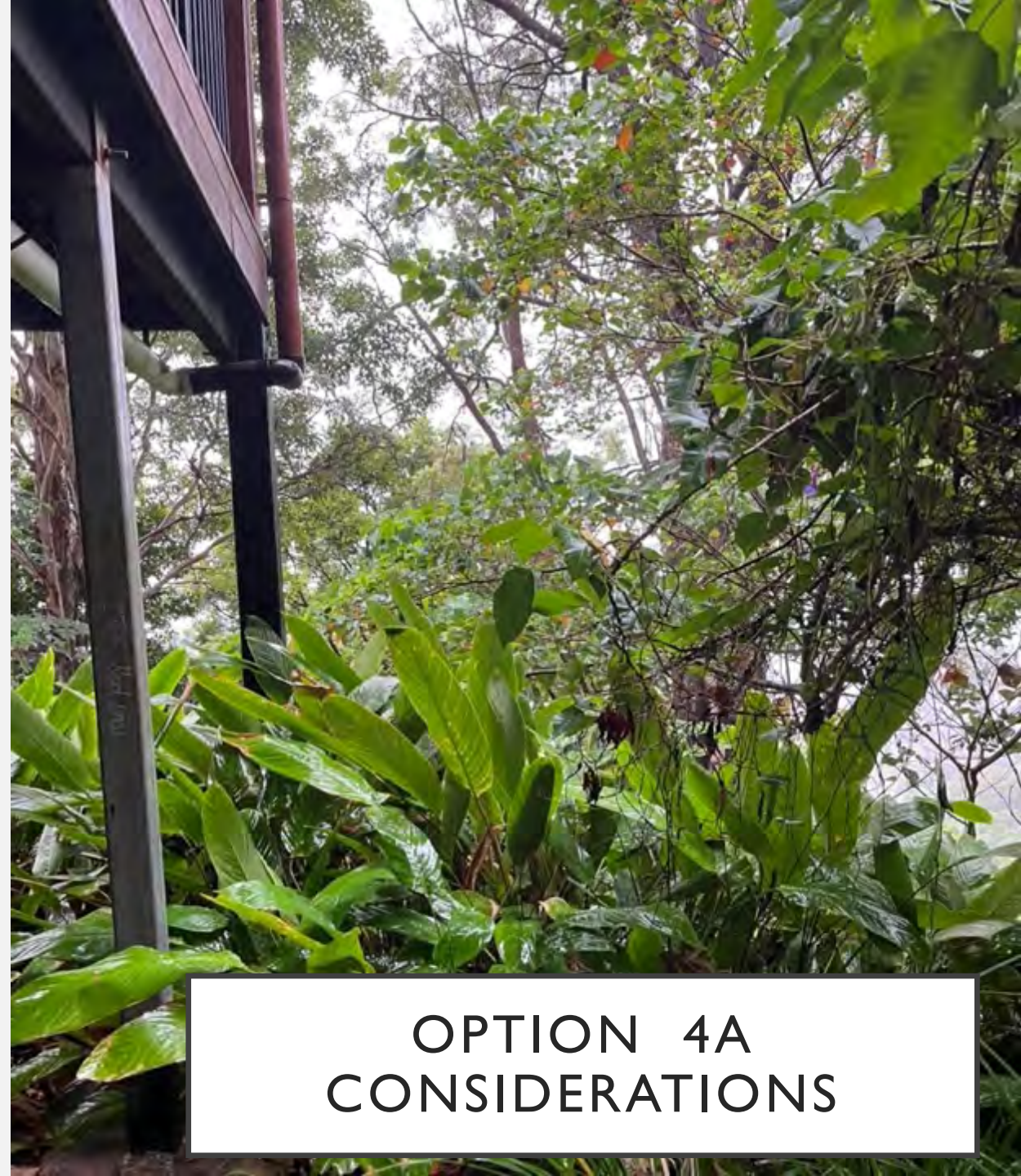

OPTION 4A
CONSIDERATIONS



HOW TO MAKE BEST USE OF SPACE

AN EVERY DAY LIVING MEMORIAL FOR
CONNECTING WITH EVERY DAY







POSSIBLE FEATURES

- Dry creek bed
- Fixed memorial stones amongst loose stones
- Indigenous sculptures
- Bush tucker plants
- Logs as walkway, climbing
- Plaques with QR codes for history of engagements



SHARE YOUR THOUGHTS

- What would you like to see?
- Draw a sketch
- Describe in words
- Send a photo
- Come and Talk
- Let's have your ideas by 25 March next General Meeting
- Email Cate Patterson cate.patterson@jayb.com.au
- Or Phone 0427790472

